

# PRINCIPAL PARTICULARS

CONSTRUCTION	ALUMINIUM	ENGINES	to be advised
MEASURED LENGTH	20.6m	FUEL	to be advised
LENGTH OVERALL	21.5m	WATER	1x500L
LENGTH HULL	21.3m (70')	SULLAGE	1x1000L
LENGTH WATERLINE	20.4m	SURVEY	-
MOULDED DEPTH	3.1m (1.75 to MAINDECK)	BALLAST	-
BEAM MOULDED	7.5m	PASSENGERS	8
DWL	1.0m (HULL)	CREW	2

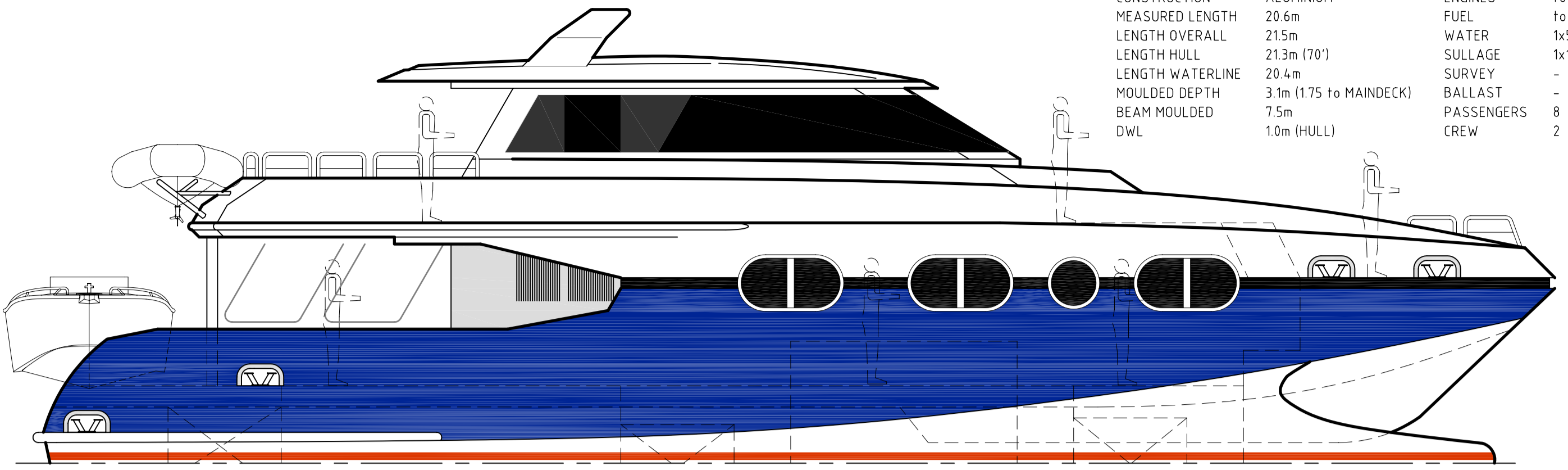

PROFILE

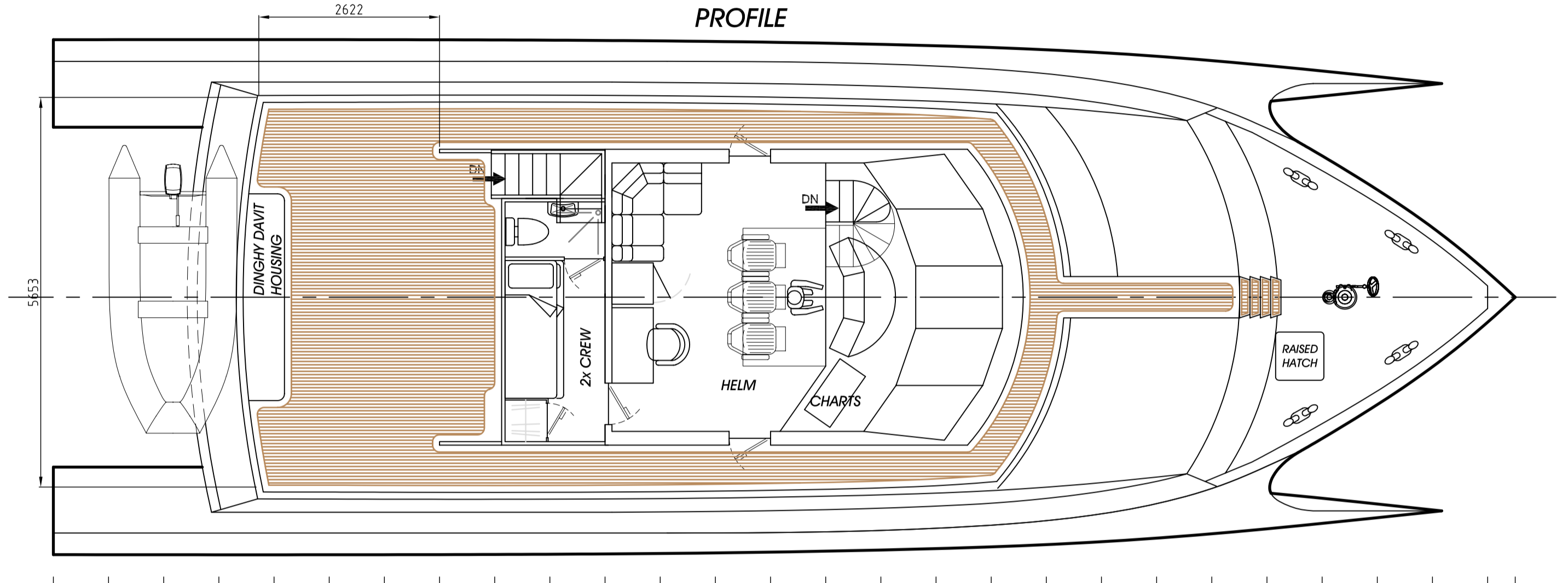

UPPERDECK PLAN

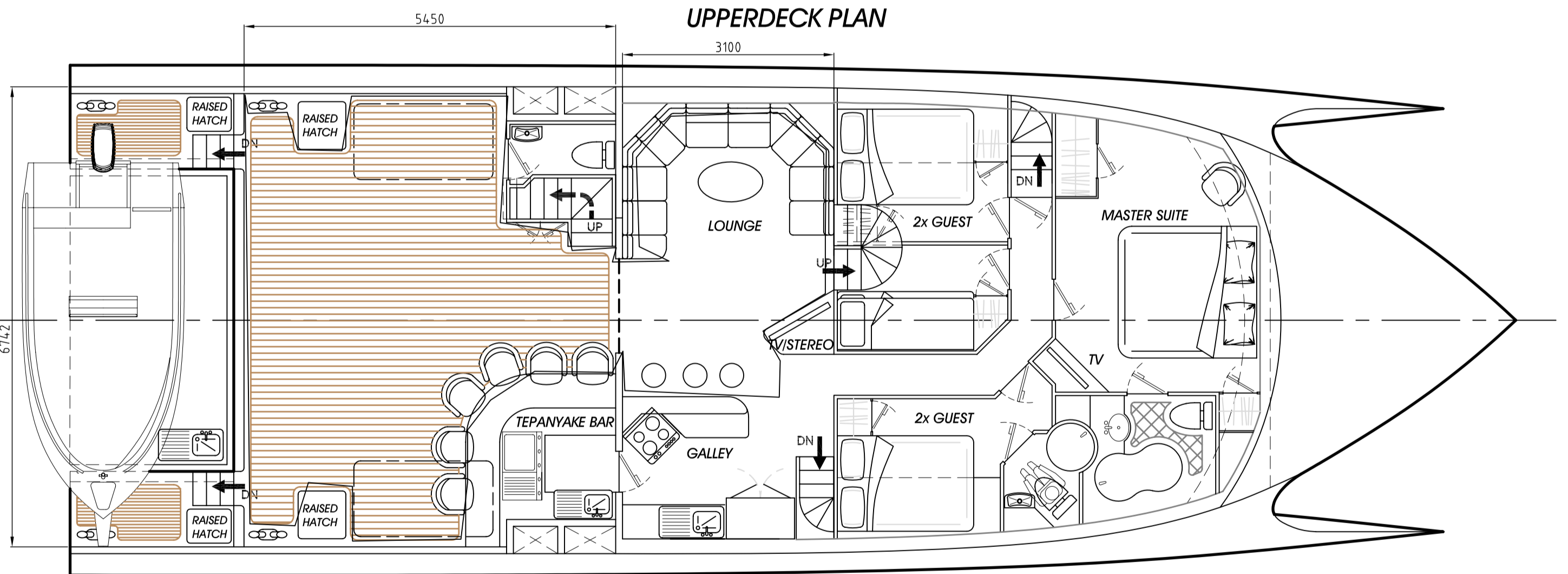

MAINDECK PLAN

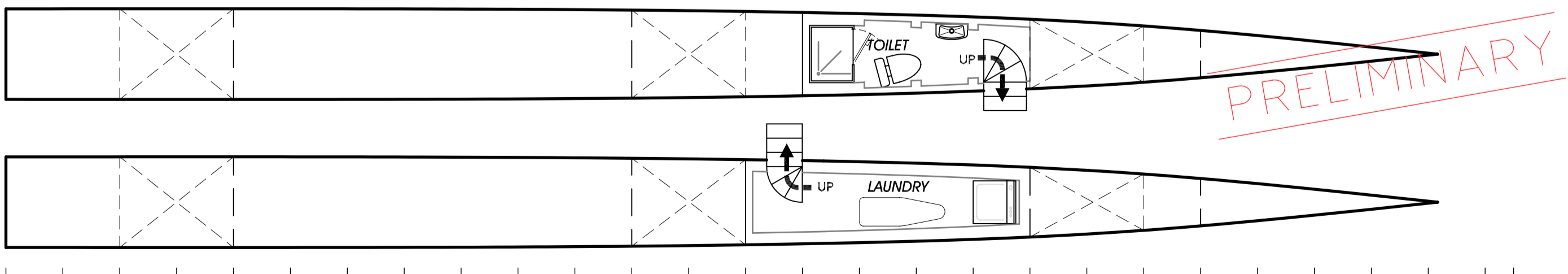

HULLS PLAN

© 1995-2005 SCHWETZ DESIGN



UNIT 7/28 WYUNA COURT HEMMANT QLD 4171  
PH: 07 3393 6909  
FAX: 07 3393 6919

TITLE: GENERAL ARRANGEMENT

PROJECT: 21m WAVE PIERCER CATAMARAN

DESIGN BY: SCHWETZ DESIGN  
NAVAL ARCHITECTS AND ENGINEERS  
www.nomadmarinekits.com

THIS DRAWING, THE COPYRIGHT AND ALL OF THE INTELLECTUAL PROPERTY IN THIS DRAWING IS OWNED BY SCHWETZ DESIGN. THIS DRAWING MAY NOT BE REPRODUCED WITHOUT PRIOR WRITTEN PERMISSION FROM SCHWETZ DESIGN. THIS DRAWING IS ISSUED SUBJECT TO OUR STANDARD TERMS AND CONDITIONS AND MUST BE RETURNED ON DEMAND. THIS DRAWING DOES NOT FORM PART OF ANY CONTRACT UNLESS SPECIFIED IN WRITING. THIS DRAWING IS SCHEMATIC IN NATURE AND WILL BE REFINED AS THE DESIGN IS DEVELOPED.

DRAWN: A.E.S.

ENGINEER: A.E.S.

NUMBER

DESIGN No. : PD394

SCALE: 1:60 A2

DATE: 7-10-05

PD394-3

ISSUE

A

ISSUE	DESCRIPTION	DATE	DRAWN
A	FIRST ISSUE	7-10-05	AES